

SV2 & SV3 SERIES

2 - 6 PSIG RELIEF



VACUUM SEAL-OFF VALVES AND VALVE OPERATORS

Features

- Vacuum Tight Seal
- Tamper Resistant
- Easy Access to Vacuum
- Functional & Reliable
- Full Flow Design
- Low Profile & Compact Design

Applications

- High Vacuum Tanks
- High Vacuum Dewars
- Low Pressure Gas Systems
- Vacuum Insulated Cryogenic Piping Systems
- Cold Box Vacuum Systems



Technical Data

Operating Ranges

Temperature-20°F to +150°F;
-29°C to +66°C

Relief Pressure2 to 6 PSIG

Materials of Construction

Body300 Series S/S
or 6061 Aluminum

PlugBrass (1" valve plug
300 Series S/S)

Disc300 Series S/S

O-RingViton®

CapAll SV2, Plastic
SV3 - 1/4" & 3/8",
Plastic
SV3 - 1/2", 3/4" & 1",
300 Series SS

Poppet300 Series S/S or
6061 Aluminum

Tests

Seat LeakageMass spec. less than
1x10⁻⁹ scc GHe/sec
(Exclusive of O-ring
Permeability) at
Ambient Temp.

Connection

Valve.....Butt Weld

OperatorISO Flange or Tube

Valve Size

1/4" to 1"

SV2 & SV3 SERIES

2 to 6 PSIG RELIEF

How To Order

SV3 - 088 - 1 W3

VACUUM SEAL-OFF VALVE

- SV2 - Relieving
- SV3 - Relieving

VALVE SIZE

- 082 - 1/4" {SV3 Only
- 083 - 3/8"
- 084 - 1/2"
- 086 - 3/4"
- 088 - 1"

CONFIGURATION

- W3 - Welded
- S3 - Socket Connection

CONSTRUCTION

- 1 - 6061 Aluminum
- 5 - 300 Series Stainless Steel

Valve Operators used in conjunction with valves during pumping operation:

VO3 - 088 T

VALVE OPERATOR

VO3 Series

OPERATOR SIZE

- 082 - 1/4"
- 083 - 3/8"
- 084 - 1/2"
- 086 - 3/4"
- 088 - 1"

*VACUUM PUMP CONNECTION

- T - OD Tube
- F - ISO Flange
- 1/4" & 1/2" - DN16,
- 3/4" & 1" - DN25

Dimensions

SV3 Seal-Off Valve with Metal Relieving Cap
(SV2 Similar, with Relieving Plastic Cap)

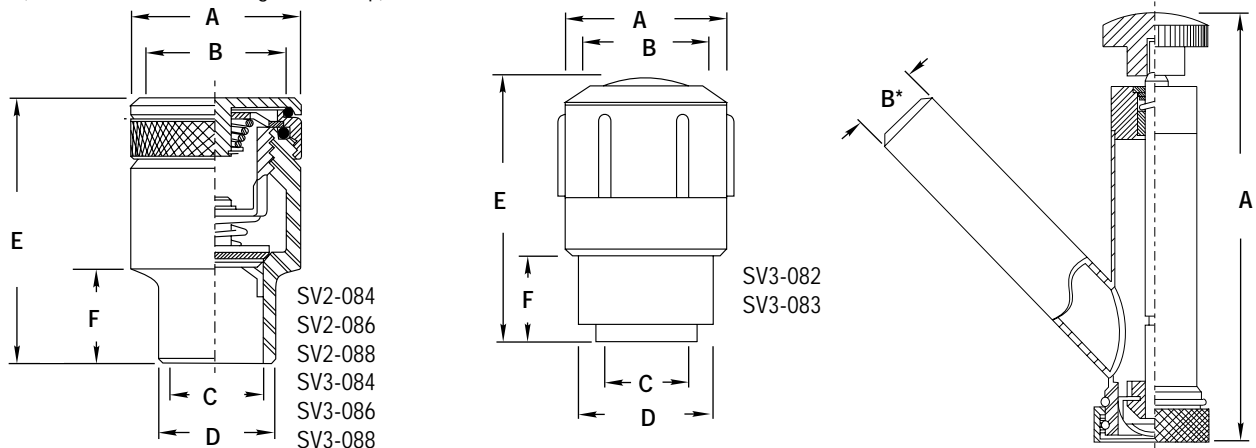

SV1 & SV3 SERIES VALVE DIMENSIONS

Part No.	A	B	C	D	E	F
SV2-084-	1.25	1.06	0.50	0.75	2.10	0.75
SV2-086-	1.63	1.38	0.75	1.00	2.50	0.75
SV2-088-	1.88	1.63	1.00	1.25	2.84	0.94
SV3-082-	0.75	0.56	0.31	0.63	1.32	0.38
SV3-083-	1.00	0.75	0.50	0.88	1.63	0.63
SV3-084-	1.19	1.06	0.50	0.75	2.00	0.39
SV3-086-	1.54	1.38	0.75	1.00	2.13	0.75
SV3-088-	1.75	1.63	1.00	1.25	2.75	0.88

VO3 SERIES OPERATORS

STAINLESS STEEL DIMENSIONS

Operator Part No.	A	B*
VO3-082-	4.38	0.625
VO3-083-	4.38	0.625
VO3-084-	4.38	0.625
VO3-086-	4.63	0.875
VO3-088-	5.00	1.125

*Optional ISO Flange.